

NATTY

User's Manual

Preface

Thank you very much for purchasing our scooters. And welcome to join the driver's line of MORTCH motorcycle.

With its extraordinary advantages of excellent quality, smart appearance and shape of legerity, our product will surely bring the utmost pleasure and convenience to your life.

This manual gives you information about the general structure, function, operation and maintenance methods of NATTY. In order to enable your beloved motorcycle to render a best performance and a longer life, please read this manual carefully, pay particular attention to the running-in part in it and follow all the operating instruction. It is of great importance to make your riding safer and more comfortable. Experienced staffs in our sale agency and the maintenance shop will also offer excellent service for you.

- Please take an initial examination of your motorcycle after the first 300km running in our designated maintenance shop, and take regular examination in every 1000km thereafter.
- All the direction, illustration and specification included in this manual are based on the latest product information. Please be noted that they may be different from the actual status of the motorcycle if there is new revision on its specification, and no further advice will be given.
- This motorcycle was designed and manufactured which complied with e-mark, the safety standard of Europe Union, the maximum speed is 25 km/h. Please do NOT change any parts without professional advice and use non-original parts in case of avoiding danger to driver and the broken of traffic laws.

CONTENTS

Guidance	1
Position of parts	3
Controlling parts	4
Starting pedal	6
Fuel tank	6
Fuel and engine oil	6
Pre-riding inspection	7
Engine starting	8
Regular maintenance	10
Tools	16
Technical Parameters	17
Electrical Circuit Chart	19

☐ **Guidance**

Please keep safety in your mind and observe the regulations of transportation while enjoying your riding. Pay attention to the following rules:

1. Pre-riding inspection

Please read the details in the relevant chapter for your safety.

2. Helmet

Do remember to wear helmet while riding.

3. Being familiar with motorcycle operation

It is of great importance to ensure your safety getting familiar with motorcycle operation.

4. Speed limitation

Drive at proper speed in accordance with the road condition, the weather and your driving skill.

WARNING

It is dangerous to drive on the wet road.
Do not make an abrupt turning while accelerating and keep proper distance from other vehicles.

5. Positions of the numbers

The frame number and the engine number are for the purpose of registering the motorcycle. When your motorcycle needs inspection, repair or other special service, the number will enable you to get good service from our sale agency. Please note down the number here:

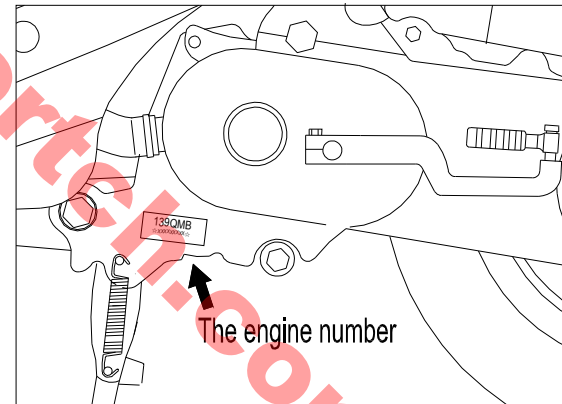
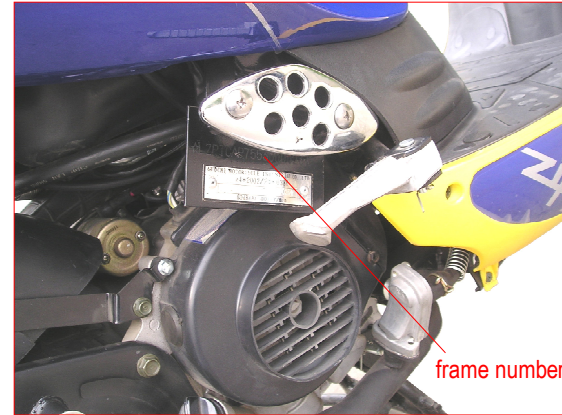

☐ The frame number: _____

☐ The engine number: _____

□ Position of parts

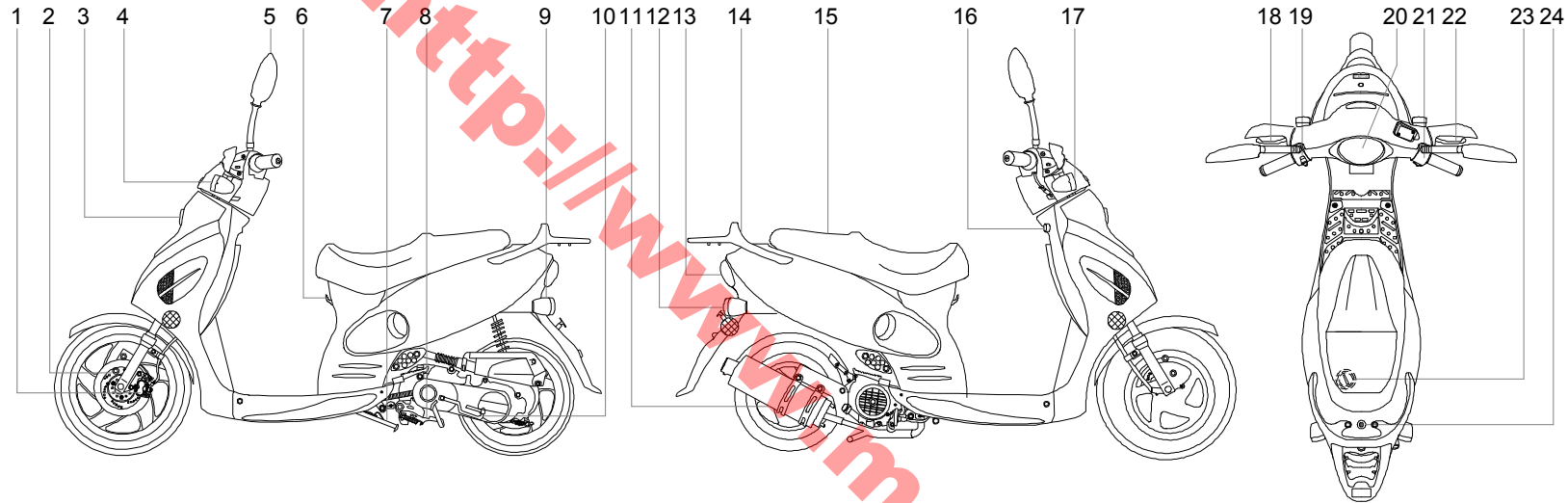

- (1) Disk brake assy.
- (2) Brake disc
- (3) Head light & position light
- (4) Left front turning light
- (5) Rear-view mirrors
- (6) Helmet hook
- (7) Side stand
- (8) Main stand

- (9) Left rear turning light
- (10) Starting pedal
- (11) Muffler
- (12) Right rear turning light
- (13) Taillight
- (14) Hand-hold
- (15) Seat
- (16) Ignition switch

- (17) Right front turning light
- (18) Rear brake lever
- (19) Left switches assy.
- (20) Meters
- (21) Right switches assy.
- (22) Front brake lever
- (23) Fuel tank cap
- (24) Seat lock

□ Controlling parts

1. Rear brake lever

Hold it tight and the rear brake functions

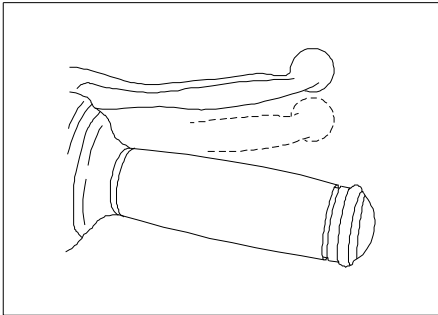

2. Switches on the left handle

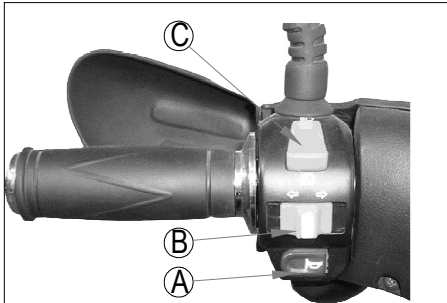

A. Horn button

B. Turning signal switch

⇐ Left turning light

⇒ Right turning light

C. Switch for high/low beam lights

3. Meters and indicating lights

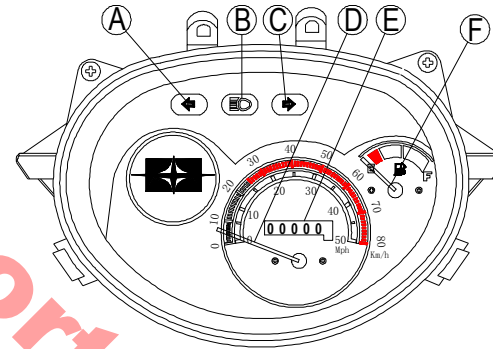

A. Left turning lights indicator

B. High beam indicator

C. Right turning lights indicator

D. Indicates the speed in km/h and Mph

E. Indicates total distance the motorcycle has run

F. Fuel gauge.

4. Front brake lever

Hold it tightly and the front brake functions.

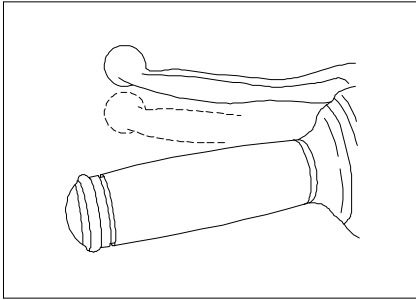

5. Switches on the right handle

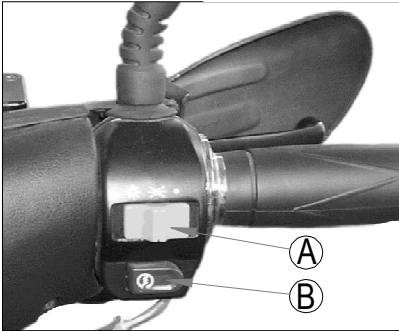

A. Head light switch

B. Electric starting button

When the ignition switch is at ON position, hold the brake and push the button and then the engine works.

6. Ignition switch

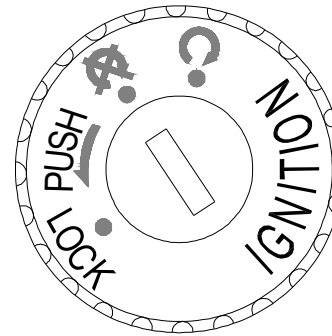

OFF: The whole circuit is cut. Engine and lights cannot be operated and the key can be withdrawn.

ON: Engine can be started and all the lights can be operated. The key cannot be withdrawn.

LOCK: Turn the steering handle fully to the left, slightly press the key and turn it to the position lock. Then the key can be taken out.

☐ Starting pedal

Starting pedal is for kicking start of the engine.

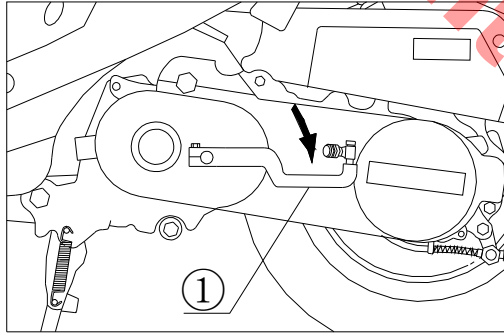

Warning

- ◆ Turn off the engine when refilling the tank.
- ◆ Turn off the cap slowly.
- ◆ Don't overfill the gasoline over the designated scale
- ◆ Do not add anything into the gasoline.

☐ Fuel tank

Usage of the cap:

1. Insert the key and open the seat.
2. Turn the cap counter-clockwise and take out it.
3. Align the lock tongue on cap with the notch on fuel tank, turn the cap clockwise and tighten it.

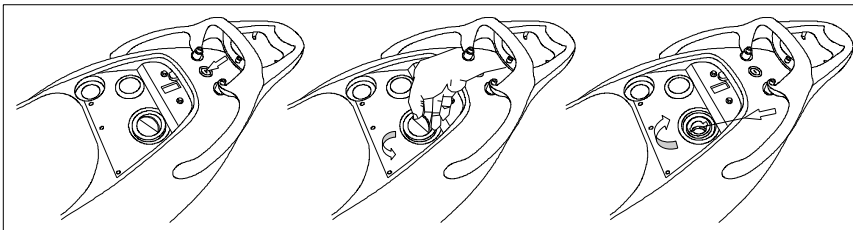

☐ Fuel and engine oil

A. Gasoline

High-quality fuel is essential to the engine.
Any sand in the fuel is absolutely prohibited.
90# or higher quality lead-free gasoline is preferred.

B. Engine oil

SAE15w/40

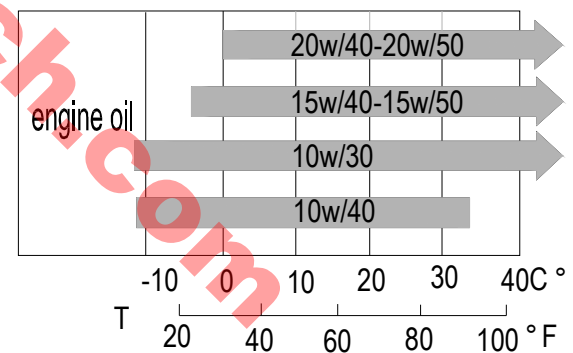

☐ Pre-riding inspection

Please check the following parts before you drive:

No.	Items	Inspection content
1	Steering handlebar	1.Flexibility 2.No gap or loosing appearance
2	Brake system	1.Travel of front brake and rear brake 2.No break on the cable 3.Flexible function
3	Tires	1.Proper pressure 2.No crack or cutting
4	Fuel	Sufficient fuel
5	Engine oil	Sufficient engine oil
6	Lights	Workable
7	Horn	Workable
8	Gear oil	With normal stock
9	Throttle	1. Proper gap 2.Flexible function 3.Proper control lever returning
10	All the bolts and nuts	No loosing appearance.

□ Engine starting

1. Please check the volume of machine oil and gasoline before starting. The main stand should be stood up while starting the engine.
2. Turn the ignition switch to the "ON" position.

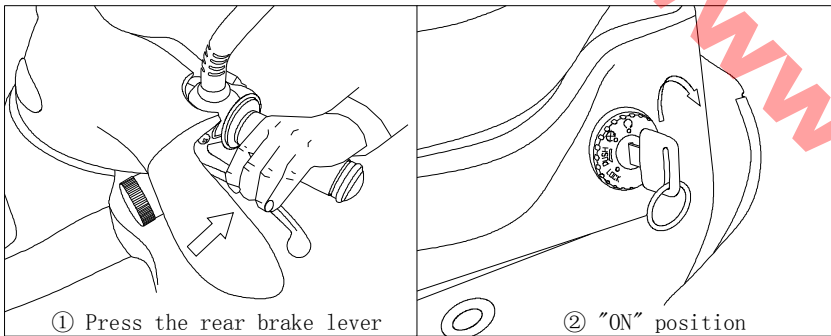

Warning

- ◆ Press the rear brake lever in case that the motorcycle rushes forwards abruptly.

3. Engine Starting

Push the starting button and then the engine can be started.

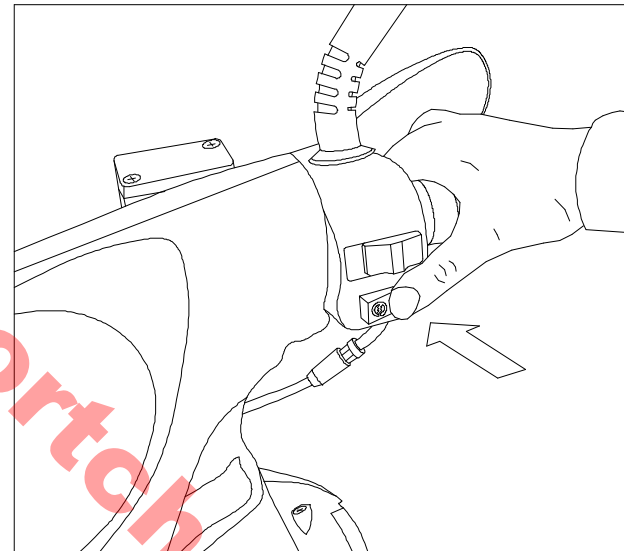

Warning

- ◆ 5 seconds is the maximum limit for each starting and 10 seconds is the minimum interval.
- ◆ Stop pressing the starting button immediately after the engine starts.
- ◆ Do not press the starting button while the engine is running, or the start motor will be damaged.
- ◆ When using electric starting, please press the rear brake lever in advance to get through the circuit and start the motor.
- ◆ When using electric starting, don't operate the starting motor continually, or it may cause damage to the starting motor and the battery.
- ◆ Warm up the engine after cold starting (about 3 minutes).

Warning

- ◆ After the engine starts, the starting pedal should be put back to its original position. Otherwise, it will affect the driver's driving.
- ◆ Please don't start the engine in unventilated places because the wasted gas with CO is harmful to human being.

4. Kick Starting

Press the brake handle, tread the starting pedal heavily and then the engine can be started.

☐ Regular maintenance

Interval	Km	300	1000	3000	6000	12000
Item	Month	New motor	1	3	6	12
Battery		I	I	I	I	I
Engine oil strainer				C	C	
Gasoline strainer						R
Carburetor		I		I	I	C
Air cleaner core		Clean it every 2000km and replace when necessary				
Spark plug		Clean it every 3000km and replace when necessary				
Fuel throttle			A	A	A	A
Drive belt					I	I
Engine oil		R	R	Replace every 3000km		
Brake system		I	I	I	I	I
Front fork and steering stem bearing		I	I		I	I
Suspension		I		I	I	I
Tires		I	I	I	I	I
Fastening nuts and bolts		I	F		F	F
Gear oil		R	Replace every 5000km / 5Month			
Rear brake cam					C	

NOTE: I=Inspect and clean 、 adjust 、 replace or lubricate as necessary: C=Clear, R=Replace, F=fastened
Service more frequently when riding in dusty areas.

1. Battery

12V/5.7Ah battery

- ① When the voltage is less than 11.5V, please use kick starting instead of electric starting.
- ② Place the ignition switch to OFF position before battery replacement.
- ③ Electrode identification: "+"—red line, "—"—green line.
- ④ Change a new battery every 4 years.

2. Carburetor and idling speed adjustment

- ① Keep the engine warmed up for 2-3 minutes.
- ② Adjust the idling speed adjusting screw to set the engine at speed of 1900 ± 100 r/min.



Idling speed adjusting screw

Warning

- ◆ It has been fully adjusted to the highest position when manufactured.

3. Air cleaner

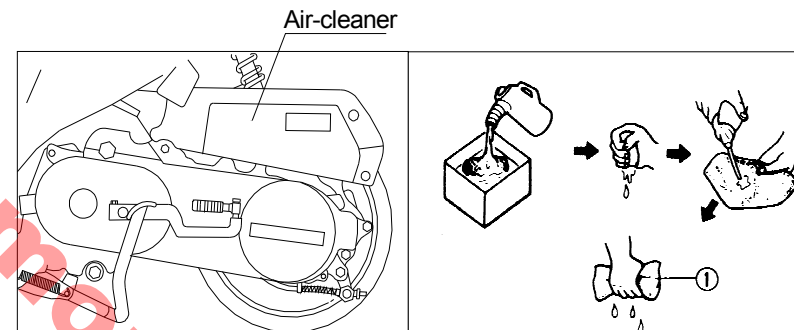

- ① Pour the non-flammable detergent into a basin and immerse the sponge core of air cleaner into the detergent.
- ② Press the core to squeeze the detergent out of it by palms. Never twist it in case that it is broken.

- ③ Immerse the core into engine oil.
- ④ Squeeze the excessive oil out but keep it lightly oil immersed.

4. Spark plug

- ◆ Clean the carbon deposit on the spark plug with a piece of hard wire or steel needle.
- ◆ Adjust the gap to 0.6-0.7mm with a thickness gauge.
- ◆ Use A7RC when replacement is needed.

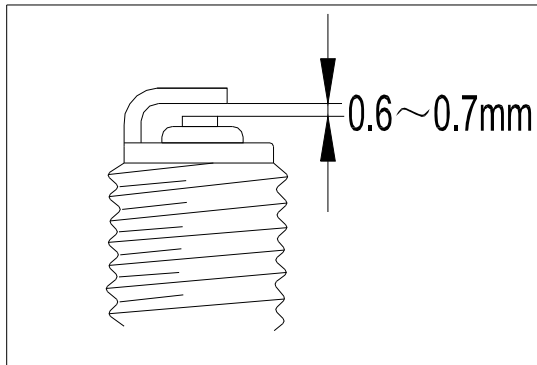

5. Fuel

Refill the recommended 90# or higher quality lead-free gasoline when the indicating needle in the fuel gauge points to the red area.

NOTE: Lead-free gasoline will extend the life of spark plug and catalytic converter.

6. Engine oil

Replace the engine oil under the condition of the engine is warm.

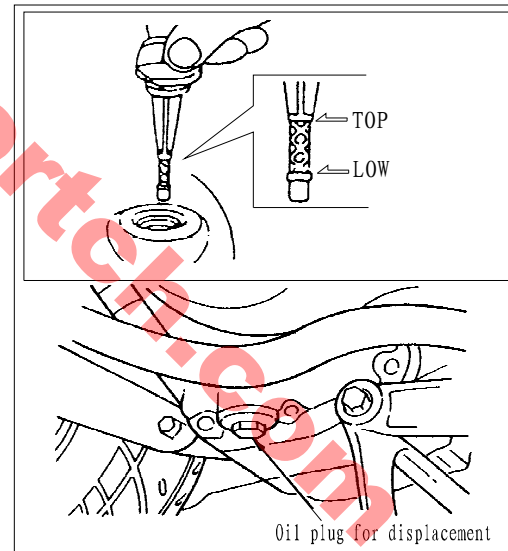

- ① Remove the oil dipstick.
- ② Remove the oil plug for displacement to drain the used oil.
- ③ Reinstall the oil plug, paying attention to be tightened.
- ④ Refill 0.8 L recommended fresh oil.
- ⑤ Fasten all the nuts and screws.

7.Brake system

Normal free travel of the brake lever is about 10-20mm.

①The front brake

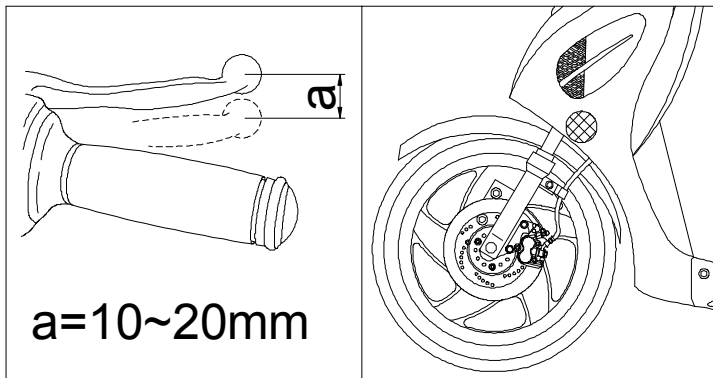

- ② The rear brake
Turn the adjusting nut to get a proper travel.

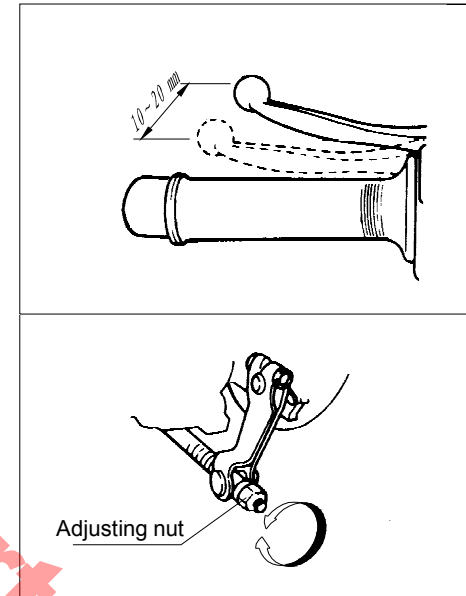

Warning:

- ◆ FREE TRAVEL means the distance between the positions from free status to the beginning performance of the brake.
- ◆ Pay attention to the sensitivity of the brake.

☆ Front brake

◆ Grip the brake lever and check the wear and tear indicator. If the indicator nearly touched the brake disc, please ask the appointed maintainer to change the brake blocks.

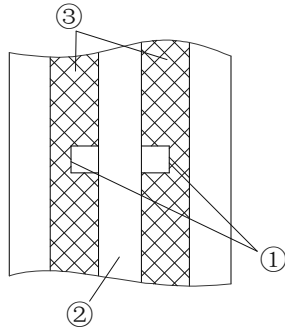

① wear and tear indicator ② brake disc ③ brake blocks

◆ Check the following items of brake system before driving the motorcycle:

- ① Check if there is any leakage.
- ② Check if there is any leakage or crack on the oil pressed hose.
- ③ The brake lever should be kept with a certain free swing distance of 10~20mm, and kept a certain re-grip power.
- ④ Abrasion situation of the brake blocks.

◆ Brake oil level

① It has been filled with the special brake oil before the motorcycle leaves the factory. User should fill or replace the recommended brake oil (such as No.DOT3 or DOT4 brake oil) from the appointed maintenance station. Never change or mix other oil, otherwise it would damage the brake system.

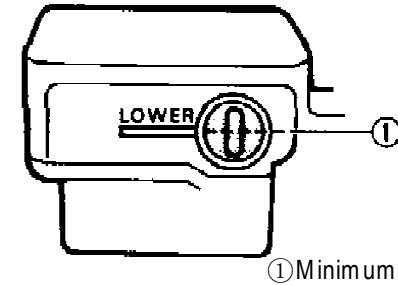

① Minimum level

② If the brake oil is insufficient, it might be possible for the air to come into the brake system, and result in the failure of the system.

Warning

- ◆ Brake oil is corrosive material. It would damage and corrupt the painting of the part. It should be cleanout if the oil splash on the part.
- ◆ If the oil sprayed on the skin or eyes, it should be cleaning quickly with a lot of water.

8. Tires

Insufficient tire pressure hastens wear of them and affects the riding stability. Please check the tire pressure and tread depth when applying regular maintenance.

- ① Tire pressure: front 250 kPa, rear 250 kPa.
- ② Tread depth: It is suggested to replace a new tire when the tread depth is less than 1 mm.

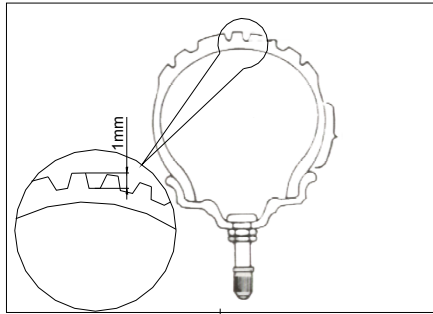

Warning:

- ◆ The standard tire is 120/70-12 56J for front and 3.50-10 51J for rear. The use of tire other than standard may cause trouble.
- ◆ Tire inflation pressures and the general tire condition are extremely important to the proper performance and safety of the vehicle.

9. Starting motor

Check the fastening bolts and the carbon brush, and replace them if necessary.

10. Fuse

Fuse is linked with the outer line of the battery. When a light or circuit fails suddenly, check the fuse first.

Warning:

- ◆ The fuse cannot be replaced by any iron or aluminum wire.

11. Gear oil

Please use the recommended gear oil: SAE85W/90

Total capacity: 110ml

Replacing capacity: 100ml

How to change gear oil

- Stand up the scooter.
- Take off the oil plug for refill.
- Take off the oil plug for displacement, let off all the used gear oil.
- Tighten the oil plug for displacement.
- Refill gear oil and tighten the oil plug after refilling.

☐ Tools

A full set of tools is offered for your daily use.



NOTE: After replacement, please make sure you have locked the oil plug.

□ Technical Parameters

Items		Specifications
Size	Length	1895mm
	Width	755mm
	Height	1045mm
	Wheel base	1285mm
Weight	Unloaded weight	92kg ± 3kg
	Mass weight	250kg
Capacity	Max. Speed	25km/h
	Slope	≥16.8°
Circuit system	Spark plug	A7RC
	Battery	12V/5.7AH
	Fuse	10A
	Headlight	12V 35/35W
	Front turning lights	12V 10W
	Rear turning lights	12V 10W
	Brake light	12V 21/5W
	Position lights	12V 5W
Volume of the fuel tank		4.5L ± 0.5L
Volume of the engine oil		1L

Items		Specifications
Engine	Model	139QMA
	Type	4 stroke
	Cylinder	1
	Bore and stroke	39mm×41.4mm
	Cylinder volume	49cm ³
	Compression ratio	10.5±0.1:1
	Max. Power	2.61kw/8000r/min
	Max. Torque	3.56N • m/5500r/min
	Idling speed	1900±100r/min
	Carburetor	PD19
	Air cleaner	Sponge core
	Ignition type	CDI
	Starting mode	Electric/kicking start
	Cooling mode	Forced air-cooled
	Lubrication	Pressure spray
Brake system		Front: disk brake Rear: drum brake
Suspension	Front shock absorber	Variable-pitch spring & hydraulic damping shock absorber
	Rear shock absorber	Variable-pitch spring & hydraulic damping shock absorber
Tires		Front: 120/70-12 56J Rear: 3.50-10 51J

